

External Looseboxes

Saltire Stables offer design excellence at affordable prices - tailor-made for a demanding life, with highly specified, competitively priced quality Looseboxes. This means they include across the range as standard, features such as a generous 1.2m (4') canopy for extra weather protection, additional bracing supports and a special cantilever roof design which is incredibly strong.

A full specification is detailed later but all the buildings feature as standard fully pressure treated maintenance free weatherboarding (no summer creosoting!), top quality kiln dried stress graded structural framing (all fully planed with nice rounded edges). We also widely use the ONDULINE roofing system, believing this to be both economic and technically superior to traditional felt.

The "standard" loosebox is 12 x 12' nom and is suitable for most horses up to 16.3HH, but we also offer in our pricelists 10 x 12' and 14 x 12' nom for ponies or hunters. Of course we can tailor make to any size to suit your needs - we've even made 6' wide individual stalls for Shetlands! For cornerboxes we offer a generous 18 x 12' nom size - why settle for anything less?

The standard eaves height of 2.24m (88") is sufficient for most customers but some breeds and conformations could use extra height and increases up to 2.54m (100") are available. Of course we can tailor make our buildings to individual preferences. Options range from as simple as increasing the cladding thickness to adding a clock tower!

The three "off the shelf" ranges are called the **TAY, FORTH and CLYDE**. The **TAY** is our introductory budget range of buildings and features include a 760mm square perspex safety window and 1.2m (4') wide doors (with all ironmongery), gable ventilators, kicklining to 1.2m (4') and Onduline roofing.

You can upgrade the TAY from the options list but why not simply specify the **FORTH** range? Chosen by around 70% of our customers, most extras are included as standard in a great value package. Hopper windows, additional ventilators, front & rear guttering, full height kickboarding, dooredge chewstrips, lined canopy and a free choice of roof colour are standard.

Finally for the most demanding of customers and horses we offer the **CLYDE** range. Tough, rugged and durable, these stables include 4 x 2 nom CLS framing, 19mm nom exterior cladding and 18mm interior kicklining, multislatted louvre windows, uprated doors with steel sheet protection, and roofs with sarking and alloy profile clad sheeting; all standard in this prestigious package.

All models can of course be made in any size or shape of layout development. The range of buildings includes all the other rooms necessary to create the perfect working environment - tack and feedstores, haybarns, corner and foaling boxes and isolation rooms. You can then add other sections like restrooms, implement stores, offices or garages - again in any combination.

How to Order a Saltire Stables Building

On the following page, we show a number of possible ideas for layout, just to give you something to think about. When you are ready simply contact us with a thumbnail sketch (on the back of an envelope will do!) or just a brief note of what you need. On receipt of your ideas we will

- 1) Turn it into a proposal with a baseplan / fixed price quotation for this particular layout
- 2) Return it to you within 5 working days
- 3) This will give you something to work on and amend as required. The plan will also show basework details so that you can obtain quotations.
- 4) Repeat process 1-3 as required until the layout is just what you want.
- 5) Request a site visit should you need help to finalise your needs.

If you intend to order from us, the following items are free of charge (If you want us simply to prepare plans there will be a small fee).

- 6) When the baseplan is correct, if planning is needed, we will prepare elevation drawings and forward a full technical data pack.
- 7) When ready, place your order verbally and agree an approximate erection date.
- 8) Confirm your order in writing and forward the 25% deposit.
- 9) We will write to you confirming matters and keep in regular touch about delivery
- 10) Let us know no later than 10 days before delivery of any Equine Essential extras.

Now relax and watch our erection team do a first class job, efficiently and to the highest standard!

Standard Features of Tay, Forth & Clyde Ranges

CCA Pressure treated maintenance free weatherboarding
 Stress Graded, kiln dried, dressed structural framing
 Minimum 2.24m (88") eaves height
 High performance Roofing system with 15 year guarantee
 Heavy Duty cantilever roof trusses / purlins
 1.2m (4') wide stable doors with chewstrip to bottom door and full ironmongery
 Loosebox kicklining to minimum 1.2m (4')
 Perspex safety window with weldmesh antinosing grill
 Free choice of solid, 1200mm weldmesh chathole, or 1.2m tall partitions

	TAY	FORTH	CLYDE
Full Height OSB kickboarding	option (1/2 ht std)	yes 12mm	yes 18mm
19mm nom (16mm fin) exterior weatherboarding	option	yes	yes
Lined upper door	option	yes OSB	yes TGV
Lined Overhang	option	yes	yes
Front or rear 112mm Guttering	option	yes	yes
Door opening Chewstrip capping	option	yes	yes
Rear wall ventilators	option	yes	yes
Opening perspex window	option	yes, hopper	yes, slats
Onduline roofing system	black	coloured	if required
Alloy profile clad roofing	option	option	yes
Sarking to roof	option	option	yes
Increased Eaves Height 2.54m (100")	option	option	yes
Crook & Band Hinges / Steel door sheets	option	option	yes
4 x 2 nom (38 x 89 fin) CLS framework	option (3 x 2 std)	option (3 x 2 std)	yes
Steel Upper Partition Grill	option	option	standard

DESIGN OPTIONS

Size	Customer designed stable size or profile as required. Increase eaves height to 2.4m / 8' plus for larger horses
Appearance	Amend roof profile or pitch Install clocktower and clock / weathervane Install Arched entranceway or haystore
Structural	Increase framing to 4x2 nom for stallion box Increase external cladding to 19mm nom Install insulation / vapour membrane to offices and restrooms
Ventilation	Specify additional ventilators or install additional top half doors
Roofing	Optional roof colourings in Red or Green Onduline Specify sarking to roof structure to add strength and minimise condensation Alternative coverings - Farmscape fibre cement, Alloy Profile Clad or Bardoline Shingles
Linings	Increase thickness of OSB to 18mm Alter kicklining to optional plywood of various thicknesses, MDF of V313 board Specify 19mm sawn boarding for ease of replacement
Doors	Specify 15mm rubber wallmat for protection of horses and buildings Specify alternate crook & band hinges & autolok padbolts 600mm steel sheet to the door face Specify 600mm hinged additional doorway for extra width in Foaling Box Use 15mm rubbermat on door inside to prevent mealtime agitation
Partitions	Amend door split height or choose 3 way split doors Install chathole in 50 x 50mm weldmesh Install steel barred grills with 12mm solid bars at 63mm centres Specify removeable partition in boxes for foaling time Limit partition height to 1.2m for smaller horses
Hardware	Fit external swivel feeders for ease of feeding Consider whether enough tie rings and slip rings both inside & out Allow for hay feeders and salt licks and mangers Bridle racks, hathooks, saddle racks and shelving for tackroom area
Water	Install external taps for fetlock washing and feed soaking with internal supply Install automatic drinkers to each stall
Power	Arrange local trades to fit bulkhead or fluorescent fittings with safety guards to each room Allow for 240V 13A sockets for clippers, electric fences etc. Hardwire Smoke detectors Specify external security lights and consider downlighters to front overhang

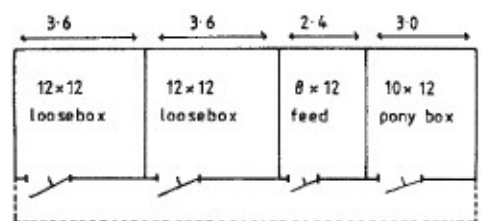

simple common layout

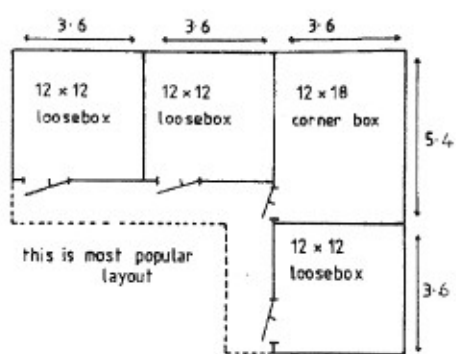

this is most popular layout

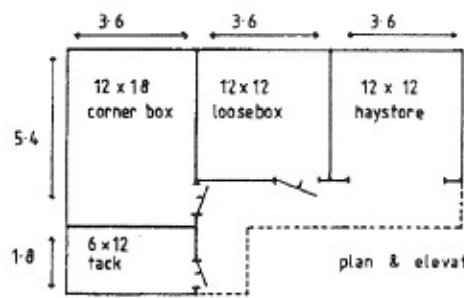

plan & elevation drawings available for any development proposal

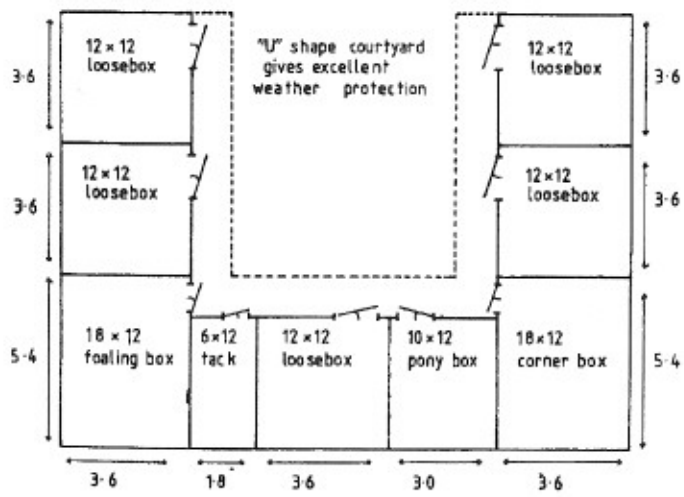

put together units in any combination

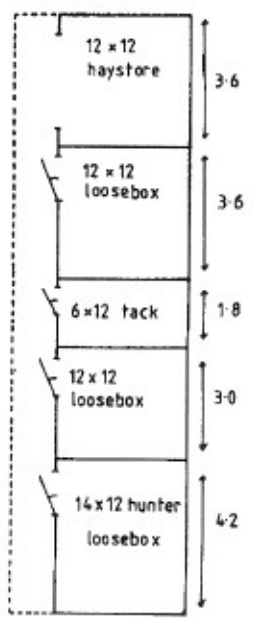

Typical Base Plan as sent to customers

